

ZHI-2017 Electromagnet

ISO/TS16949 ISO9000 ISO14000
RoHS REACH CE UL VDE TÜV

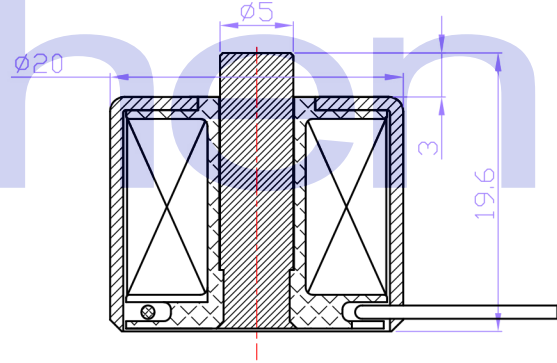

类型: 断电吸合 TYPE: DEENERGIZED SUCKER



总重量 Total Weight: 30g
应用范围: 用于纺织机械等
APPLICATION: Textile machine etc

型号 Type no.

ZHI-2017P-XX A XX

E 通电吸 Electromagnet
P 永磁吸 Permanent magnet
电压 Voltage (V)
系列号 Serial No.: A, B, C...
电阻 Resistance (Ω)

PERFORMANCE PROMETER 性能参数

单位: mm Units: mm

工作周期 (%) = $\frac{\text{工作时间}}{\text{工作时间} + \text{断开时间}} \times 100\%$ Duty cycle (%) = $\frac{\text{"ON" time}}{\text{"ON" time} + \text{"OFF" time}} \times 100\%$	连续 Continuous 100%	间断 Or less 50%	间断 Or less 25%	间断 Or less 10%
最大工作时间(秒) MAX. "on" time in seconds	∞	55	19	3
瓦特(W) (20°C) Watts at 20°C	2.4	3.6	6.4	10
保持力 holding force (gf)	250	400	550	900

ZHI-2020 Electromagnet

ISO/TS16949 ISO9000 ISO14000
RoHS REACH CE UL VDE TÜV

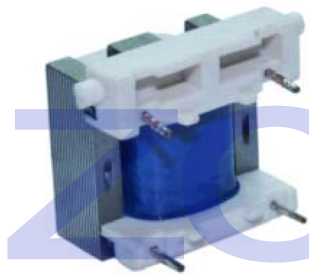

类型: 通电吸合 TYPE: ENERGIZED SUCKER

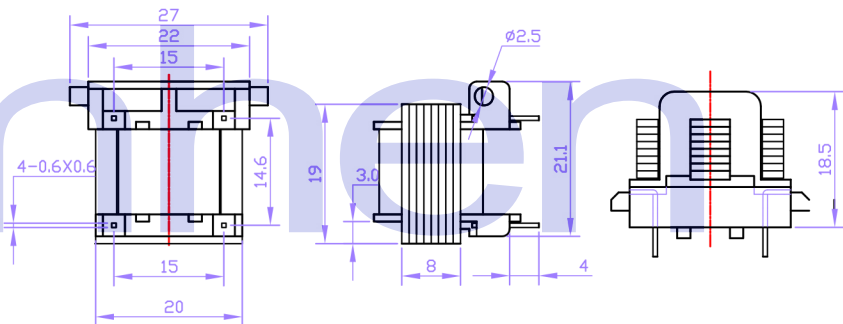

总重量 Total Weight: 25g
应用范围: 多士炉
APPLICATION: Toster

型号 Type no.

ZHI-2020E-XX A XX

E 通电吸 Electromagnet
P 永磁吸 Permanent magnet
电压 Voltage (V)
系列号 Serial No.: A, B, C...
电阻 Resistance (Ω)

PERFORMANCE PROMETER 性能参数

单位: mm Units: mm

工作周期 (%) = $\frac{\text{工作时间}}{\text{工作时间} + \text{断开时间}} \times 100\%$ Duty cycle (%) = $\frac{\text{"ON" time}}{\text{"ON" time} + \text{"OFF" time}} \times 100\%$	连续 Continuous 100%	间断 Or less 50%	间断 Or less 25%	间断 Or less 10%
最大工作时间(秒) MAX. "on" time in seconds	∞	55	19	3
瓦特(W) (20°C) Watts at 20°C	0.6	1.2	2.4	6
保持力 holding force (gf)	2000	\	\	\

电吸铁 ZHI