

ZHB-1805 Bobbin Solenoid

ISO/TS16949 ISO9000 ISO14000
RoHS REACH CE UL VDE TÜV



总重量 Total Weight: 5g
应用范围: 投币器等
APPLICATION: Coin Box etc

型号Type no.

ZHB-0518-XX A XX

电压Voltage (V)

系列号Serial No.: A, B, C...

电感Inductance (mH)

类型: 电感线圈 TYPE: INDUCTANCE COIL

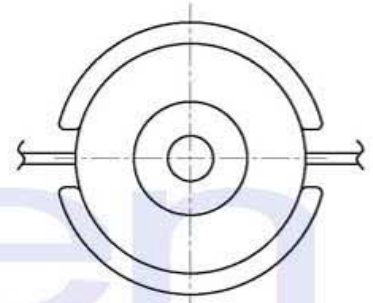
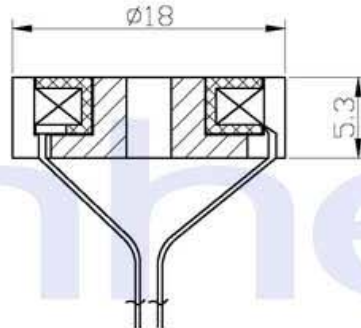

PERFORMANCE PROMETER 性能参数

工作周期(%) = $\frac{\text{ON time}}{\text{ON time} + \text{OFF time}} \times 100\%$ Duty cycle(%) = $\frac{\text{"ON" time}}{\text{"ON" time} + \text{"OFF" time}} \times 100\%$	连续 Continuous 100%	间断 Or less 50%	间断 Or less 25%	间断 Or less 10%
最大工作时间(秒) MAX. "on" time in seconds	∞	55	19	3
瓦特(W) (20°C) Watts at 20°C	0.6	1.2	2.4	6
安匝数AT(20°C) Ampere-turns at 20°C	55	78	110	176

ZHB-1809 Bobbin Solenoid

ISO/TS16949 ISO9000 ISO14000
RoHS REACH CE UL VDE TÜV



总重量 Total Weight: 6g
应用范围: 电磁铁用线包
APPLICATION: SOLENOID COIL

型号Type no.

ZHB-1809-XX A XX

电压Voltage (V)

系列号Serial No.: A, B, C...

电阻Resistance (Ω)

类型: 电磁铁线圈 TYPE: SOLENOID COIL

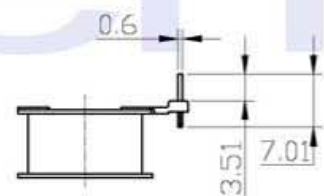
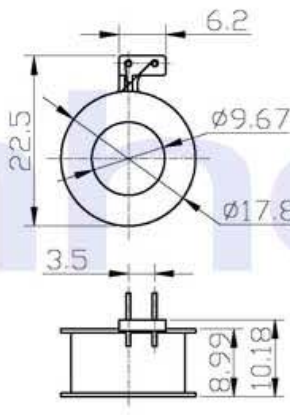

PERFORMANCE PROMETER 性能参数

单位:mm Units:mm

工作周期(%) = $\frac{\text{ON time}}{\text{ON time} + \text{OFF time}} \times 100\%$ Duty cycle(%) = $\frac{\text{"ON" time}}{\text{"ON" time} + \text{"OFF" time}} \times 100\%$	连续 Continuous 100%	间断 Or less 50%	间断 Or less 25%	间断 Or less 10%
最大工作时间(秒) MAX. "on" time in seconds	∞	55	19	3
瓦特(W) (20°C) Watts at 20°C	1.6	3.2	6.4	16
安匝数AT(20°C) Ampere-turns at 20°C	180	255	358	560

线圈式ZHB